

ASHTON
ASOKE

THE ARCHETYPE



PROJECT DETAIL

TOWER	51 FLOORS
TOTAL NO. OF RESIDENTIAL UNITS	783 UNITS
TYPES OF UNITS	1 BEDROOM, 2 BEDROOM
NO. OF PARKING	371 CARS

FACILITY

- SOCIAL CLUB
- LIBRARY
- SWIMMING POOL
- KID'S POOL
- FITNESS
- JACUZZI
- STEAM ROOM
- SAUNA ROOM

*THE USE OF COMMON PROPERTY IS SUBJECT TO THE MANAGEMENT OF THE JURISTIC PERSON.



FLOORPLAN



MASTER PLAN



12TH-15TH, 17TH-20TH, 22RD-25TH, 27TH-30TH, 32RD-34TH FLOOR



FLOORPLAN



35TH FLOOR 

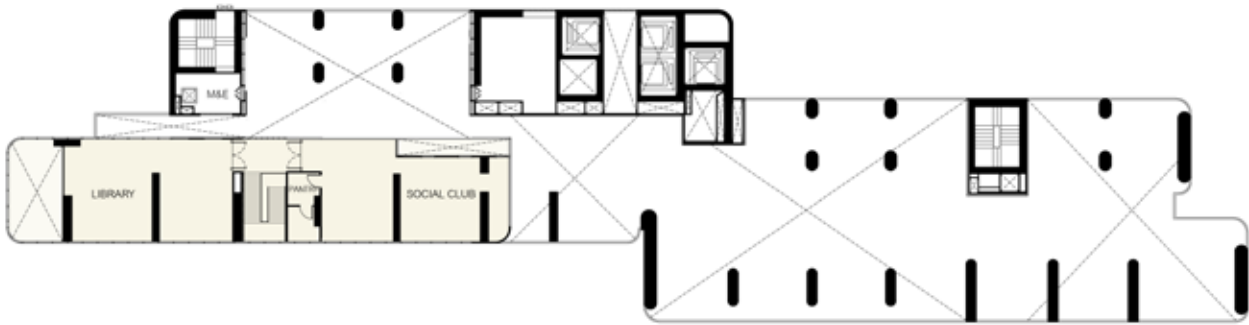

35MTH FLOOR 



47TH FLOOR 

THE FLOOR AREA SPECIFIED ARE ONLY ESTIMATES. FURNITURE PLACEMENT, ROOM RATIO AND OTHER DETAILS ARE FOR ILLUSTRATIVE AND ADVERTISEMENT PURPOSES ONLY

ROOM TYPE



TYPE DM
30.50-31.50 SQ.M.



TYPE DM-1
30.50-31.50 SQ.M.



TYPE D
30.50-33.50 SQ.M.



TYPE C
33.50-35.00 SQ.M.

ROOM TYPE



TYPE C1
35.00-35.50 SQ.M.



TYPE CM
33.50-35.50 SQ.M.

ROOM LAYOUTS AND PILLAR LOCATIONS ARE SUBJECT TO THE LOCATION OF THE UNIT



IMAGES ARE FOR ADVERTISING PURPOSE ONLY.

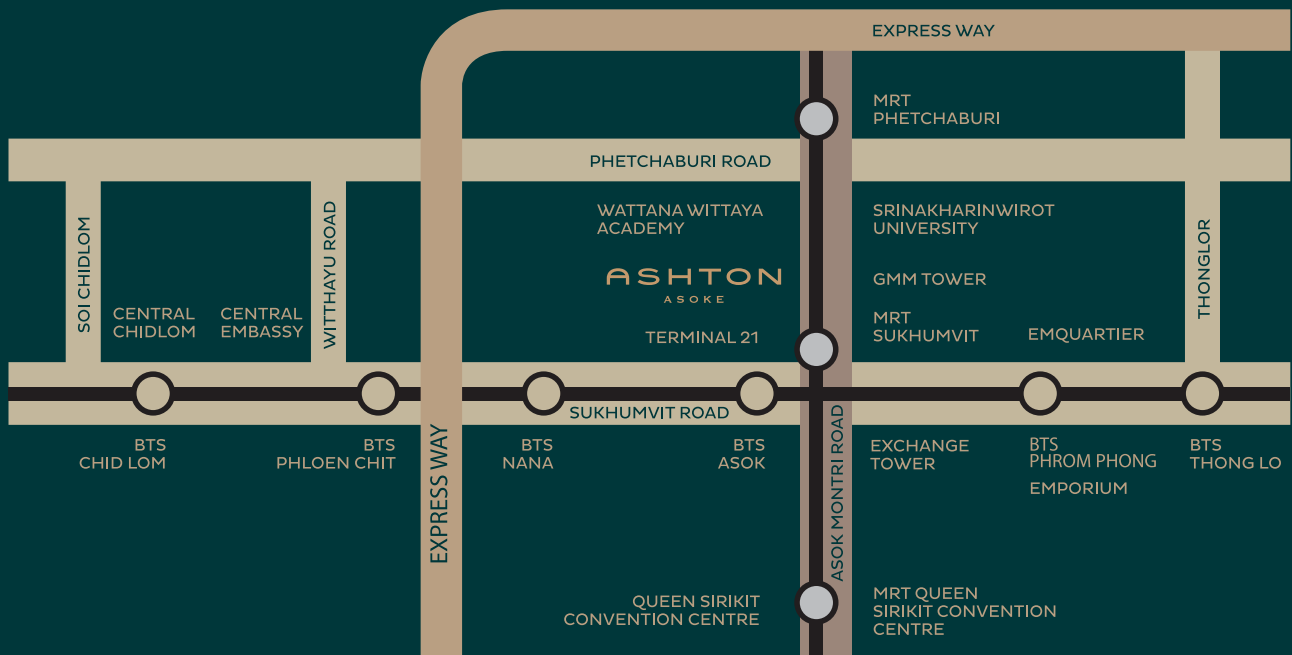

20 M. TO MRT SUKHUMVIT
230 M. TO BTS ASOK



ASHTON ASOKE, CONDOMINIUM REGISTER NUMBER 15/2561. PROJECT OWNER : ANANDA MF ASIA ASOKE CO., LTD. REGISTERED CAPITAL: 850,000,000 BAHT (EIGHT HUNDRED FIFTY MILLION BAHT – FULLY PAID). OFFICE IS LOCATED AT 99/1 MOO 14, SOI MOOBAN WINDMILL, BANGNA-TRAT (KM.10.5) ROAD, BANG PHLI YAI SUB-DISTRICT, BANG PHLI DISTRICT, SAMUT PRAKARN PROVINCE. MANAGING DIRECTOR: CHANOND RUANGKRITYA. PROJECT TYPE: ONE 51-STOREY RESIDENTIAL CONDOMINIUM WITH 783 RESIDENTIAL UNITS. COMMON PROPERTIES: SWIMMING POOL, FITNESS MULTI-PURPOSE ROOM. PROJECT LOCATION: ASOKE-MONTRI ROAD (SUKHUMVIT 21), KHLOENG TOEY NUA SUB-DISTRICT, WATTANA DISTRICT, BANGKOK. PROJECT IS LOCATED ON TITLE DEEDS NO. 2345, 2451, 2452, KHLOENG TOEY NUA SUB-DISTRICT, WATTANA DISTRICT, BANGKOK. TOTAL LAND AREA APPROXIMATELY: 2-3-47.6 RAI. THE PROJECT HAS OBLIGATIONS TO KRUNG THAI BANK PUBLIC COMPANY LIMITED.CO-OWNERS OF THE BUILDING ARE BY LAW REQUIRED TO BE RESPONSIBLE FOR ANY COMMON FEES AND TAX FEES TO BE INCURRED.